



## Monmouth Grove , Kingsmead, MK4 4AY

Situated down a desirable street in the sought after location of Kingsmead, lies this impressive five bedroom detached house with double garage and a lovely sized garden.

Offering approximately 1529sq ft of living space set over three floors, this home opens with a lovely entrance porch on to the entrance hall with cloakroom, with doors leading to all rooms to include the spacious, dual aspect living room with patio doors opening on to the garden. A kitchen, breakfast room and separate dining room complete the ground floor.

To the first floor you'll find the primary bedroom with an excellent dressing room offering plenty of wardrobe space and also a three piece ensuite shower room. There are also two further great sized bedrooms, one of which has fitted wardrobes, and the family bathroom. Whilst the second floor offers two further double bedrooms and a shared shower room.

The rear garden is mostly lawned with a small patio area and a fenced surround. The front offers a driveway with side by side parking and a double garage.

## Accommodation

Five bedroom detached house

Double garage with side by side parking

No onward chain

Ensuite, Shower Room and Bathroom

Spacious living room

Kitchen and separate dining room

Lovely garden

Sought after location





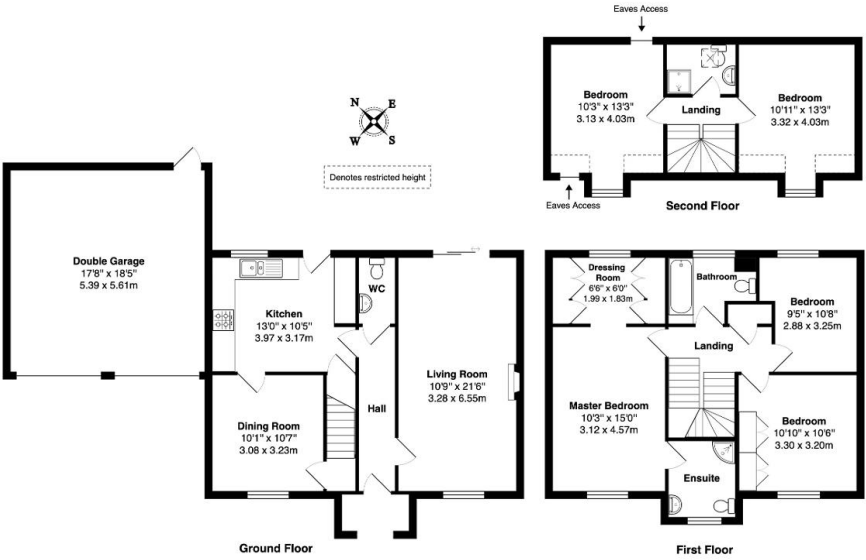

Approximate Area: 1529 ft² ... 142.1 m² (excluding double garage)  
Approximate Area of Double Garage: 333 ft² ... 30.9 m²  
Approximate Total Area: 1862 ft² ... 173 m²

Floor plans are for layout purposes only and are not intended to be scale drawings.  
All measurements, including window and door openings are approximate and should not be relied upon for valuation purposes.  
Please check all dimensions, shapes & compass bearings before making any decisions reliant upon them.  
MK Property Photography accepts no liability whatsoever for any error or omission or inadvertent mis-statement in a floor plan.  
Copyright MK Property Photography www.mkpropertyphotography.co.uk

