



Pinewood Drive , Bletchley, MK2 2HY

A beautiful three bedroom mid terraced house, pleasantly situated opposite the Grand Union Canal with a lovely green outlook on the popular 'Trees Estate'. This home boasts modern decor throughout with a stunning kitchen with wooden work tops and feature island with breakfast bar.

This spacious home offers an entrance hall with under stair storage with all rooms leading off from here with a nice sized lounge boasting a south facing bay window overlooking the front aspect. To the rear of the house you have a great sized kitchen/dining area leading onto the conservatory. The kitchen has modern shaker style, light units with solid wood work tops and feature splash back tiling. The kitchen also has a double butler sink overlooking the garden and an integrated double oven and microwave and gas hob positioned on the island. You will find the recently renovated downstairs cloakroom tucked away off the kitchen from a small inner hall. The conservatory can be used all year around and has a lovely outlook over the garden. The landscaped rear garden which features beautiful plants and flower borders offers a private and secluded spot for outdoor seating.

Accommodation

Three bedroom terraced house

Beautiful decor throughout

Landscaped rear garden

Double parking space to front

Modern kitchen with island

Consevatory

Living room with bay window

Cloakroom

The first floor boasts three generous sized bedrooms, all of which have built in storage cupboards. Bedroom one and two are both great sized double bedrooms and the third room makes a lovely single room or can double up as a home office. The bathroom offers a three piece white suite to include sink, wc and a panel bath with shower over and fully tiled surround.

To the front of the property you'll find the driveway which offers a double, side by side parking space and a small front garden area and porch.

Internal photos and floor plan of this wonderful home are soon to follow!





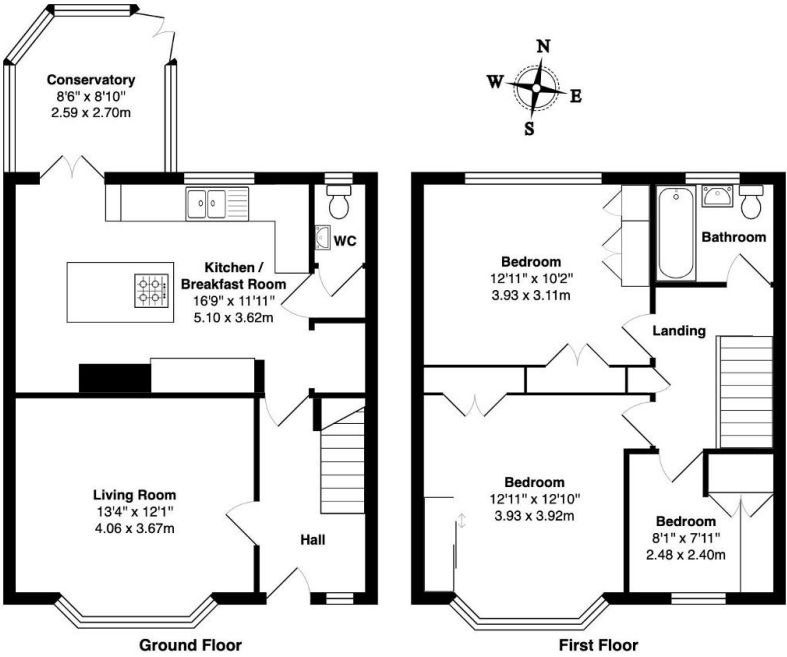

Approximate Total Area: 1024 ft² ... 95.2 m²

Floor plans are for layout purposes only and are not intended to be scale drawings.
All measurements, including window and door openings are approximate and should not be relied upon for valuation purposes.
Please check all dimensions, shapes & compass bearings before making any decisions reliant upon them.
MK Property Photography accepts no liability whatsoever for any error or omission or inadvertent mis-statement in a floor plan.
Copyright MK Property Photography www.mkpropertyphotography.co.uk

