



Woolmans , Fullers Slade, MK11 2BB

A ground floor maisonette offered for sale with tenants in situ paying £895pcm in Fullers Slade, just a short walk to the popular market town of Stony Stratford. The accommodation comprises, entrance hall, living/dining room, kitchen, two bedrooms and a bathroom. There is a private rear garden which leads off the living room.

The service charge is approximately £600 per year and the remaining lease is 92 years.

Accommodation

GROUND FLOOR
MAISONETTE

TWO BEDROOMS

LIVING/DINING ROOM

KITCHEN AND UTILITY
ROOM

BATHROOM

APPROXIMATELY 92 YEARS
LEASE

IDEAL BUY TO LET

NO ONWARD CHAIN

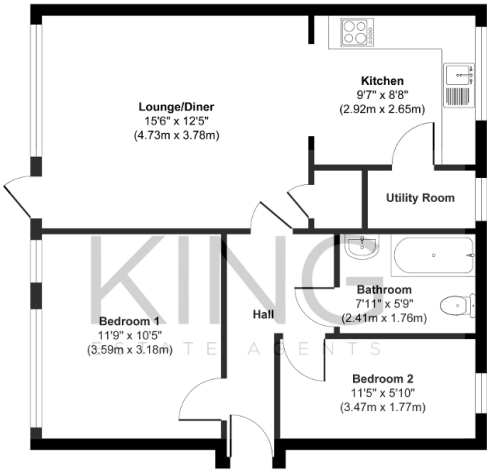

Floor Plan
Approximate Floor Area
624 sq. ft
(58.05 sq. m)
Approx. Gross Internal Floor Area 624 sq. ft / 58.05 sq. m
Floorplans are for layout purposes only and are not intended to be scale drawings.
All measurements are approximate and should not be relied upon for valuation purposes.
Produced by Elements Property