



## Sakura Walk , Willen Park, MK15 9EH

King Estate Agents are delighted to bring to market this spacious and modern, two bedroom first floor apartment in the popular Gyosei Gardens development. This apartment benefits from a modern kitchen with integrated oven, a spacious living and dining area with a balcony offering stunning views over the canal, two double bedrooms with an ensuite and balcony to the master and a further bathroom. This apartment is within close proximity to the Grand Union Canal offering pleasant walks and picturesque views. It also benefits from an allocated parking space and further visitor parking. To the front of the property there are open communal gardens which are well maintained and to the rear where you will find the parking there is also a bicycle store.

\*Approx 89 years remaining on the lease. We await service charge and ground rent figures from the owner.

## Accommodation

**TWO BEDROOM  
APARTMENT**

**FIRST FLOOR WITH TWO  
BALCONIES**

**EN SUITE AND BATHROOM**

**ALLOCATED PARKING**

**BALCONY FROM LIVING  
ROOM**

**MASTER BEDROOM WITH  
ENSUTIE AND BALCONY**

**OVERLOOKING GRAND  
UNION CANAL**

**NO ONWARD CHAIN**





Sakura Walk

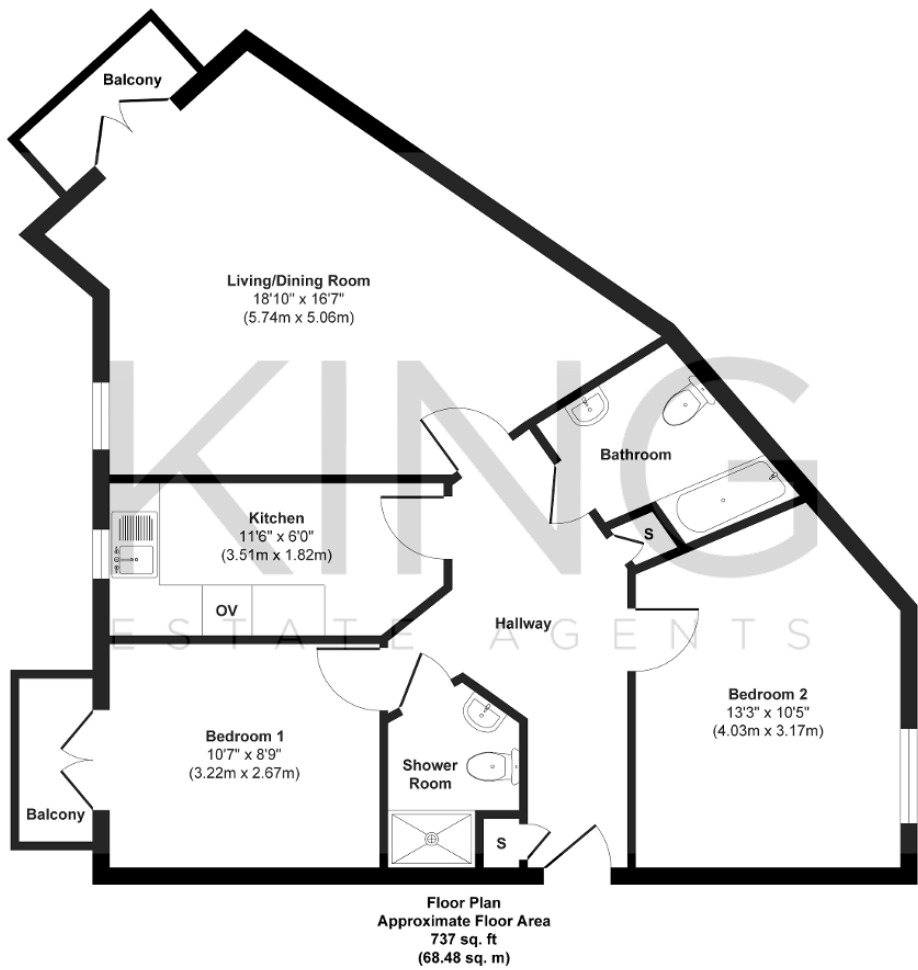

Approx. Gross Internal Floor Area 737 sq. ft / 68.48 sq. m

Floorplans are for layout purposes only and are not intended to be scale drawings.  
All measurements are approximate and should not be relied upon for valuation purposes.  
Produced by Elements Property

Energy Efficiency Rating			
Score	Energy rating	Current	Potential
92+	A		
81-91	B		
69-80	C	80  C	81  B
55-68	D		
39-54	E		
21-38	F		
1-20	G		