



North Twelfth Street MK9 3BS

King Estate Agents are delighted to offer for sale this one bedroom GROUND floor maisonette, with REAR GARDEN, situated in central Milton Keynes. The property could make an ideal buy to let or first time buy. The accommodation in brief comprises an entrance hall, bedroom, bathroom, living/dining room, kitchen, rear garden and allocated parking space.

*Leasehold information- The vendor has advised that there is a service charge of approximately £46 per month and there is approximately 82 years remaining on the lease.

Accommodation

ONE BEDROOM

GROUND FLOOR
MAISONETTE

CENTRAL LOCATION

IDEAL BUY TO LET OR
FIRST TIME BUY

GARDEN

LIVING ROOM

KITCHEN

SERVICE CHARGE APPROX
£46 PER MONTH

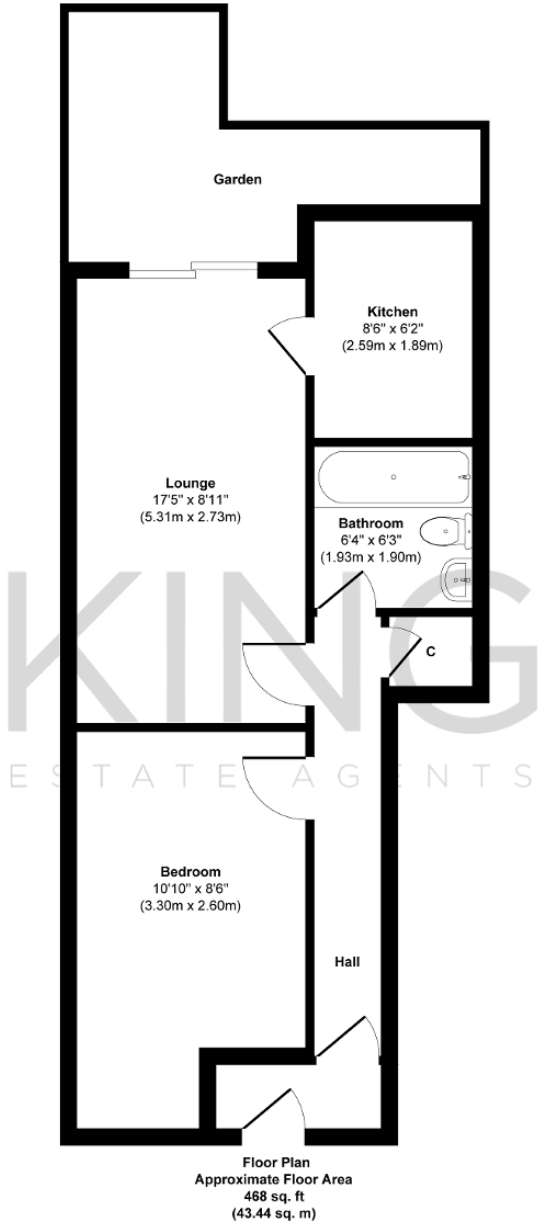

Approx. Gross Internal Floor Area 468 sq. ft / 43.44 sq. m
Floorplans are for layout purposes only and are not intended to be scale drawings.
All measurements are approximate and should not be relied upon for valuation purposes.
Produced by Elements Property

Energy Efficiency Rating			
Score	Energy rating	Current	Potential
92+	A		
81-91	B		
69-80	C	78 C	78 C
55-68	D		
39-54	E		
21-38	F		
1-20	G		