



Welbeck Close , Monkston, MK10 9HQ

King Estate Agents are delighted to bring to the market this well presented three bedroom link-detached property, situated in the sought after location of Monkston. The accommodation in brief comprises an entrance hall, cloakroom, living room and kitchen/dining room. Upstairs there is a master bedroom with refitted en suite, two further bedrooms and a refitted bathroom. Outside there are front and rear gardens and a driveway leading to a single garage.

Accommodation

THREE BEDROOM

LINK DETACHED

GARAGE

MASTER BEDROOM WITH
REFITTED ENSUITE

CLOAKROOM

LIVING ROOM

KITCHEN/DINING ROOM

REFITTED BATHROOM



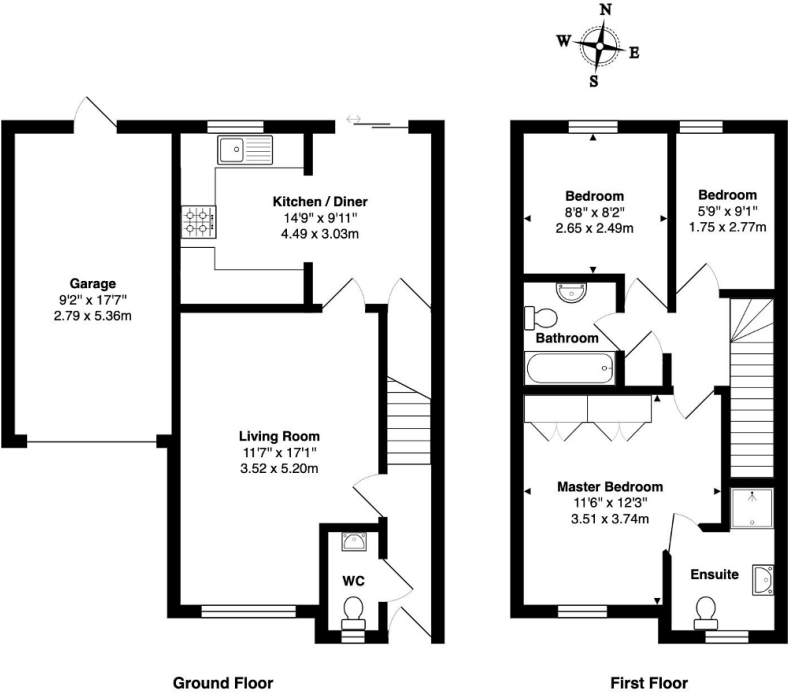

Total Area: 824 ft² ... 76.5 m² (excluding garage)
Total Area including garage: 994ft² ... 92.3m²

Floor plans are for layout purposes only and are not intended to be scale drawings.
All measurements, including window and door openings are approximate and should not be relied upon for valuation purposes.
Please check all dimensions, shapes & compass bearings before making any decisions reliant upon them.
MK Property Photography accepts no liability whatsoever for any error or omission or inadvertent mis-statement in a floor plan.
Copyright MK Property Photography.

