

KING

ESTATE AGENTS

5 Bed Semi-Detached

£625,000

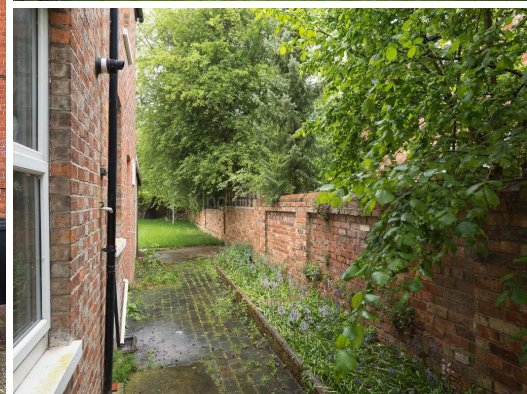

St Michaels Road MK40 2LU

King Estate Agents are delighted to bring to the market this Victorian five bedroom, semi detached home, situated down a prestigious road, within close proximity of Bedford School and the Town Centre. The property is in need of some updating and is being sold with no onward chain. The property is currently used as a HMO, so could provide an investment opportunity, but equally could be converted back to a family home. This home boasts 2317sqft of generous living space throughout and a south/west facing, walled rear garden.

Accommodation

FIVE BEDROOM PERIOD
PROPERTY

CURRENTLY USED AS A
HMO

IN NEED OF
MODERNISATION

SEMI DETACHED
VICTORIAN HOME

LIVING ROOM AND DINING
ROOM

KITCHEN AND UTILITY
ROOM

SOUTH WEST FACING
WALLED REAR GARDEN

NO ONWARD CHAIN



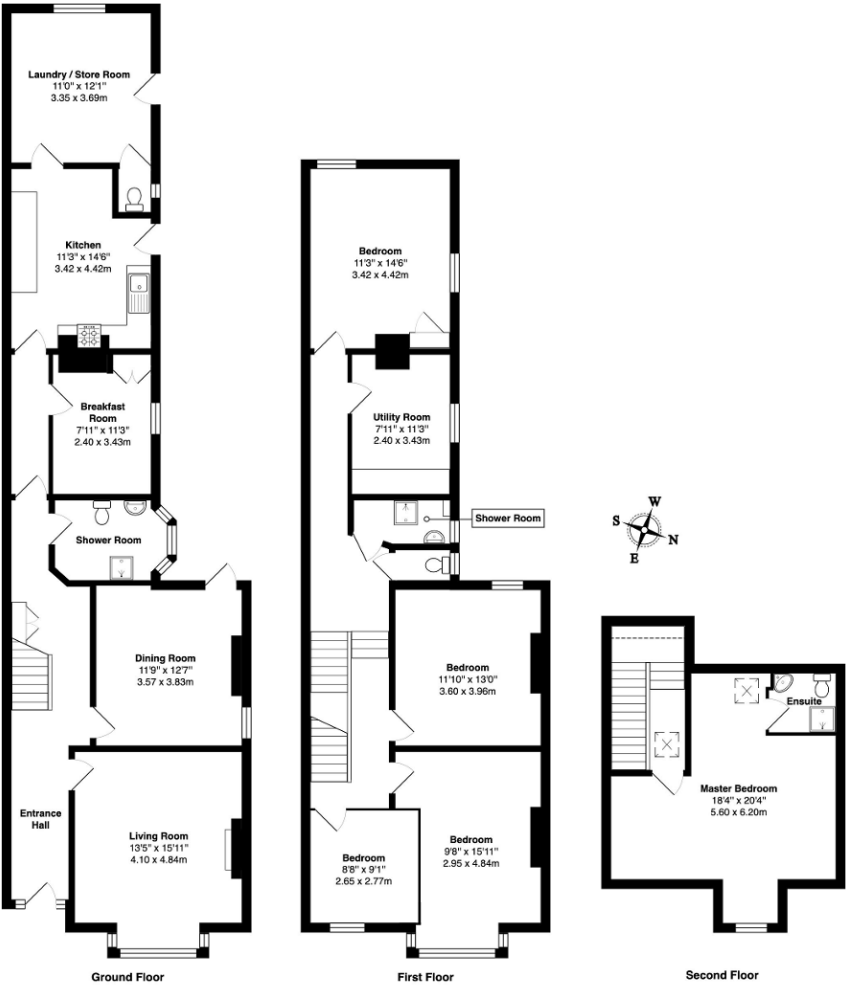

Total Area: 2317 ft² ... 215.2 m²

Floor plans are for layout purposes only and are not intended to be scale drawings.
All measurements, including window and door openings are approximate and should not be relied upon for valuation purposes.
Please check all dimensions, shapes & compass bearings before making any decisions reliant upon them.
MK Property Photography accepts no liability whatsoever for any error or omission or inadvertent mis-statement in a floor plan.
Copyright MK Property Photography.

