

KING
ESTATE AGENTS

Sold

King Estate Agents

1 BEDROOM APARTMENT | SAPPHIRE HOUSE, 315 SOUTH ROW, MILTON KEYNES | £180,000

DESCRIPTION

King Estate Agents are now in receipt of an offer for the sum of £180,900 for 55 Sapphire House, 315 south Row, Milton Keynes, MK9 2FH. Anyone wishing to place an offer on this property should contact King Estate Agents, 11 Furzton Lake, Shirwell Crescent, Milton Keynes, MK4 1GA 01908 272724 before exchange of contracts.

CASH BUYERS ONLY

King Estate Agents are delighted to bring to market this lovely one bedroom apartment in Sapphire House, situated in the exclusive Vizion development with dual aspect views to both the living area and bedroom and a fantastic outlook over towards west Milton Keynes. This property can only be sold to a cash buyer due to the ongoing cladding restoration needed within the development but makes a fantastic opportunity to purchase at a low asking price.

This property opens with an entrance hall with two storage cupboards leading onto the open plan living room with large balcony and beautiful views. The modern kitchen offers integrated appliances aswell as further storage cupboards. Bedroom one has windows to both the side and front aspect and is a generous sized double room. The bathroom is fully tiled to the walls and offers a three piece white suite to include panel bath with shower over and glass screen, wc and sink.

The property comes with one allocated parking space, with communal areas and gardens always being very well maintained. This apartment is



being sold with no onward chain.

Sapphire House is situated within the executive 'Vizion' development which is conveniently located within Central Milton Keynes and is walking distance to Milton Keynes Train Station offering a 35 minute journey into London Euston. This property is also walking distance to numerous restaurants and bars and close to Centre:mk Shopping Centre with parking at Intu Milton Keynes.







Sapphire House

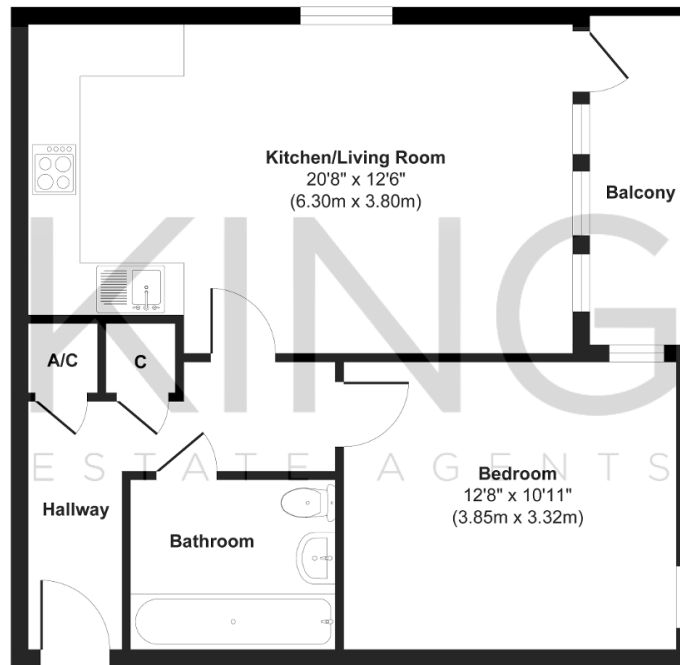

Floor Plan
Approximate Floor Area
532 sq. ft
(49.49 sq. m)

Approx. Gross Internal Floor Area 532 sq. ft / 49.49 sq. m

Floorplans are for layout purposes only and are not intended to be scale drawings.
All measurements are approximate and should not be relied upon for valuation purposes.
Produced by Elements Property

Energy Efficiency Rating			
Score	Energy rating	Current	Potential
92+	A		
81-91	B	81 B	81 B
69-80	C		
55-68	D		
39-54	E		
21-38	F		
1-20	G		

DISCLAIMER

These particulars are thought to be materially correct though their accuracy is not guaranteed and they do not form part of any contract. All measurements are approximate and we have not tested any fitted appliances, electrical or plumbing installation or central heating systems.

KING
ESTATE AGENTS

11 Furzton Lake
Shirwell Crescent
Milton Keynes
Buckinghamshire
MK4 1GA

Tel: 01908 272724
E-mail: info@kingestateagents.com
Web: www.kingestateagents.com