



## Tasmania Grove , Newton Leys, MK3 5GY

**\*IDEAL FAMILY HOME\*OVER 1000SQFT OF LIVING SPACE\***  
**MASTER BEDROOM WITH EN SUITE\*CARPORT\*** King Estate Agents are delighted to offer for sale this extremely well presented MODERN three bedroom detached home, situated in the popular residential area of Newton Leys. The accommodation in brief comprises entrance hall, cloakroom/utility room, living room, kitchen/dining room, master bedroom with en suite, two further bedrooms, and a family bathroom. Outside there is a private rear garden and carport with parking.

## Accommodation

THREE BEDROOM  
DETACHED

OVER 1000SQFT

CARPORT

LARGE KITCHEN/DINING  
ROOM

LIVING ROOM

UTILITY/CLOAKROOM

MASTER BEDROOM WITH  
EN SUTIE

TWO FURTHER BEDROOMS

## Ground Floor

**Entrance Hall** - Stairs rising to the first floor landing, storage cupboard, radiator, doors to;

**Cloakroom/ Utility Room** - Fitted to comprise low level WC, wash hand basin with cupboard under, integrated washer/dryer, radiator, double glazed window to the front aspect.

**Kitchen/Diner** - Fitted to comprise sink and drainer with mixer tap over and a cupboard under, a further range of base and eye level units, laminate work surfaces with a tiled surround, built in oven/hob with extractor over, integrated dishwasher and fridge/freezer, double glazed window to the front aspect and patio doors to the rear garden.

**Living room** - Two double glazed windows and patio doors, two radiators.



## First Floor

**First floor landing** - Access to the loft, airing cupboard, radiator, double glazed window to the rear aspect.

**Master Bedroom** - Fitted wardrobes, radiator, double glazed window to front and rear aspect.

**En suite** - Fitted to comprise double shower cubicle with wall mounted shower, pedestal wash hand basin, low level WC, radiator, double glazed window to front aspect.

**Bedroom Two** - Fitted wardrobe, radiator, double glazed window to the side aspect.

**Bedroom Three** - Radiator, double glazed window to side aspect.

**Family Bathroom** - White suite fitted to comprise panel bath with tiled surround, low level WC, pedestal wash hand basin, radiator, double window to the front aspect.



## Exterior

**Rear Garden** - Patio and lawn area.









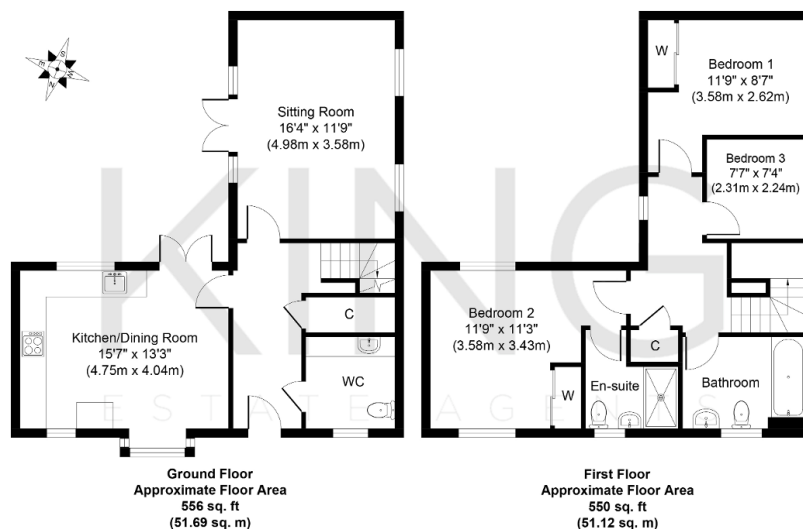

Floorplans are for layout purposes only and are not intended to be scale drawings. All measurements are approximate and should not be relied upon for valuation purposes.

